

27 Horse Kohler Engine Idle Speed Adjustment



While following these steps you will need a flat screwdriver and a pair of pliers.

While engine is running. Push throttle all the way to its lowest idle. locate the bracket holding the governor idle spring. Using a screwdriver as shown or a pair of pliers slightly bend the bracket towards the governor idle spring until rpms drop to around 1300

Bracket

Governor idle spring
which is letter F in the
diagram on page 3

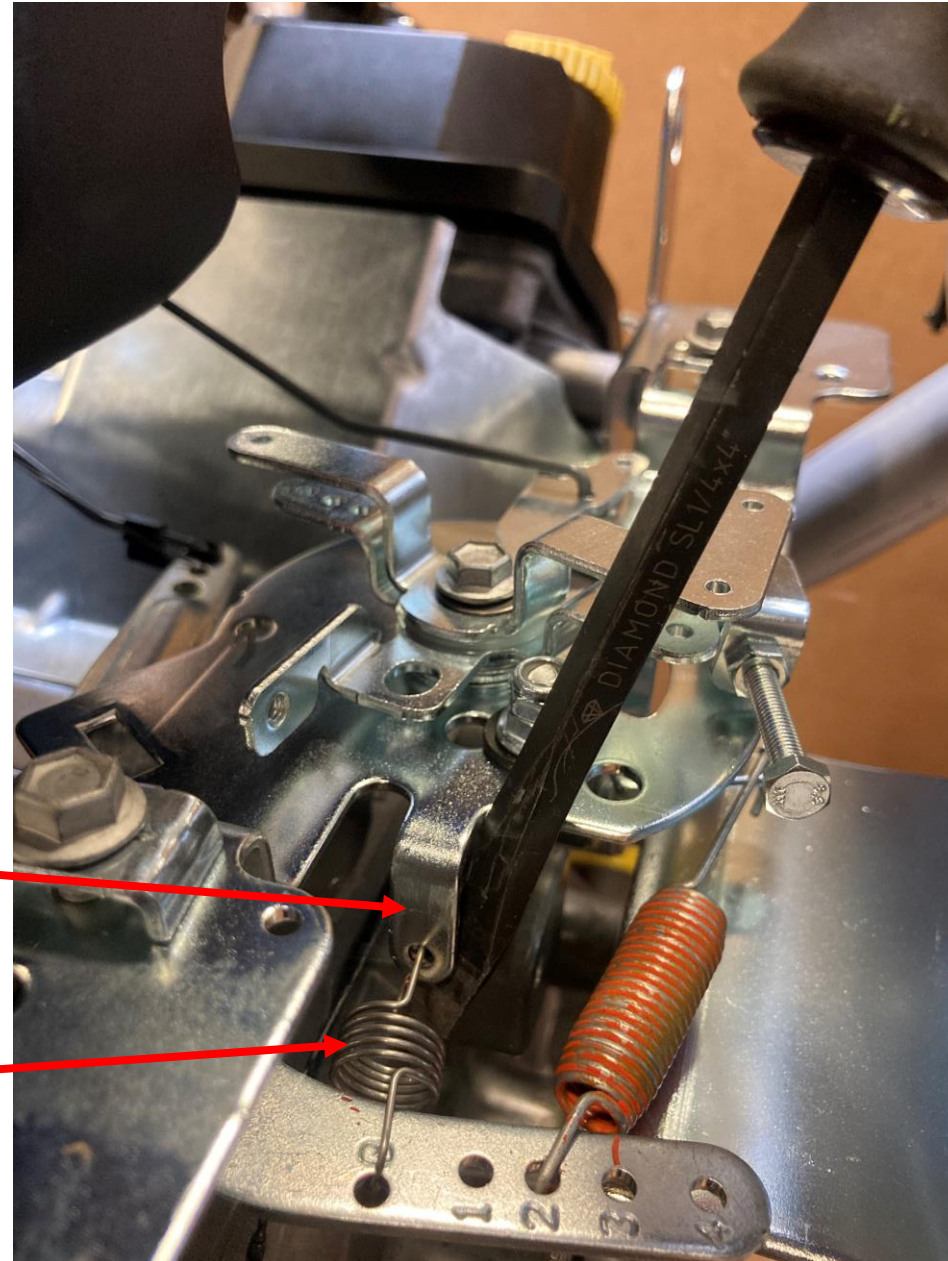

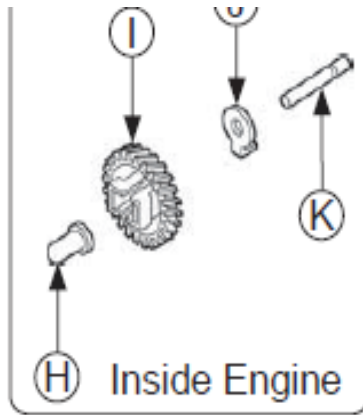

Bracket

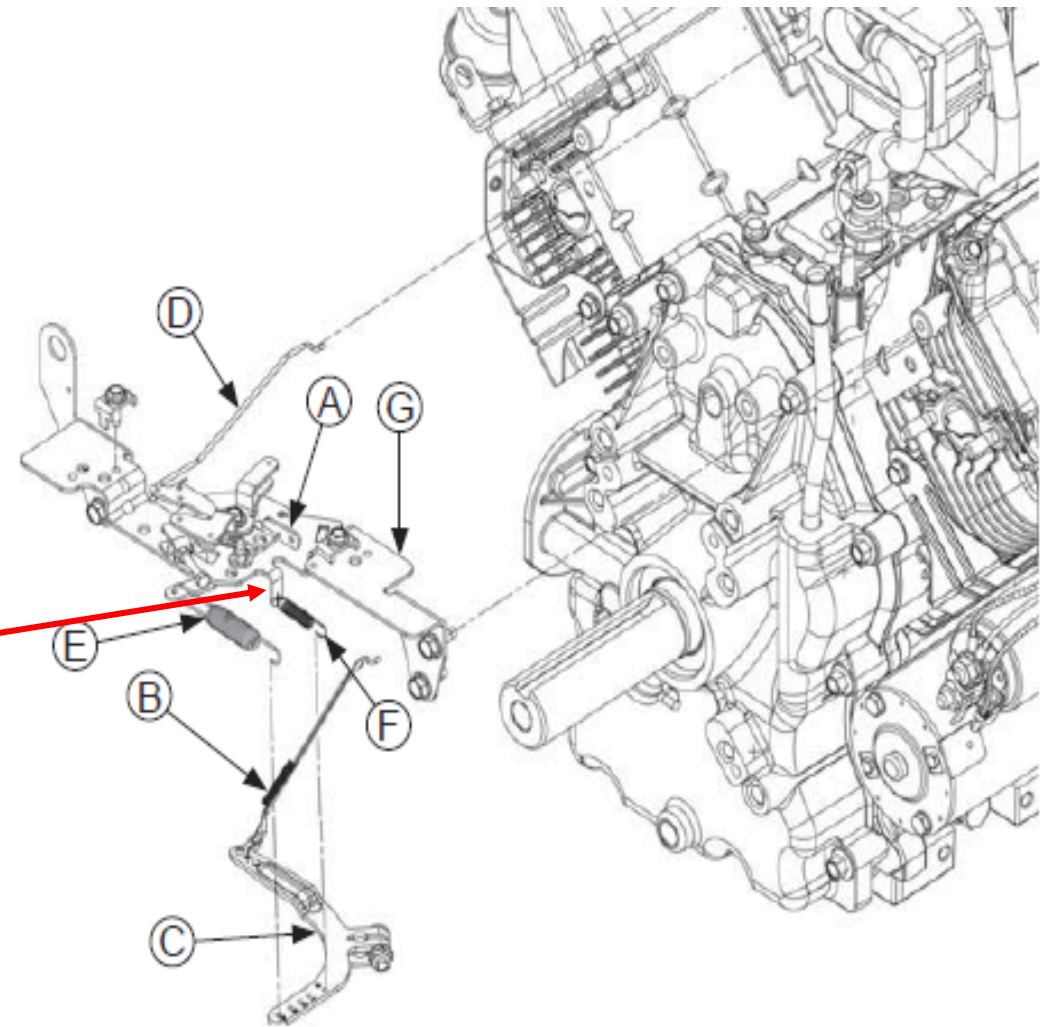

A	Throttle Lever	B	Throttle Linkage	C	Governor Lever	D	Choke Linkage
E	Governor Spring	F	Governed Idle Spring	G	Control Bracket	H	Regulating Pin
I	Governor Gear	J	Locking Tab Thrust Washer	K	Governor Gear Shaft		

While engine is still running turn the idle adjustment screw in or out to get to around 1450 to 1500 rpms at idle. 1450 to 1500 rpms is the recommended idle speed.

Idle adjustment screw is letter V in the diagram on page 5

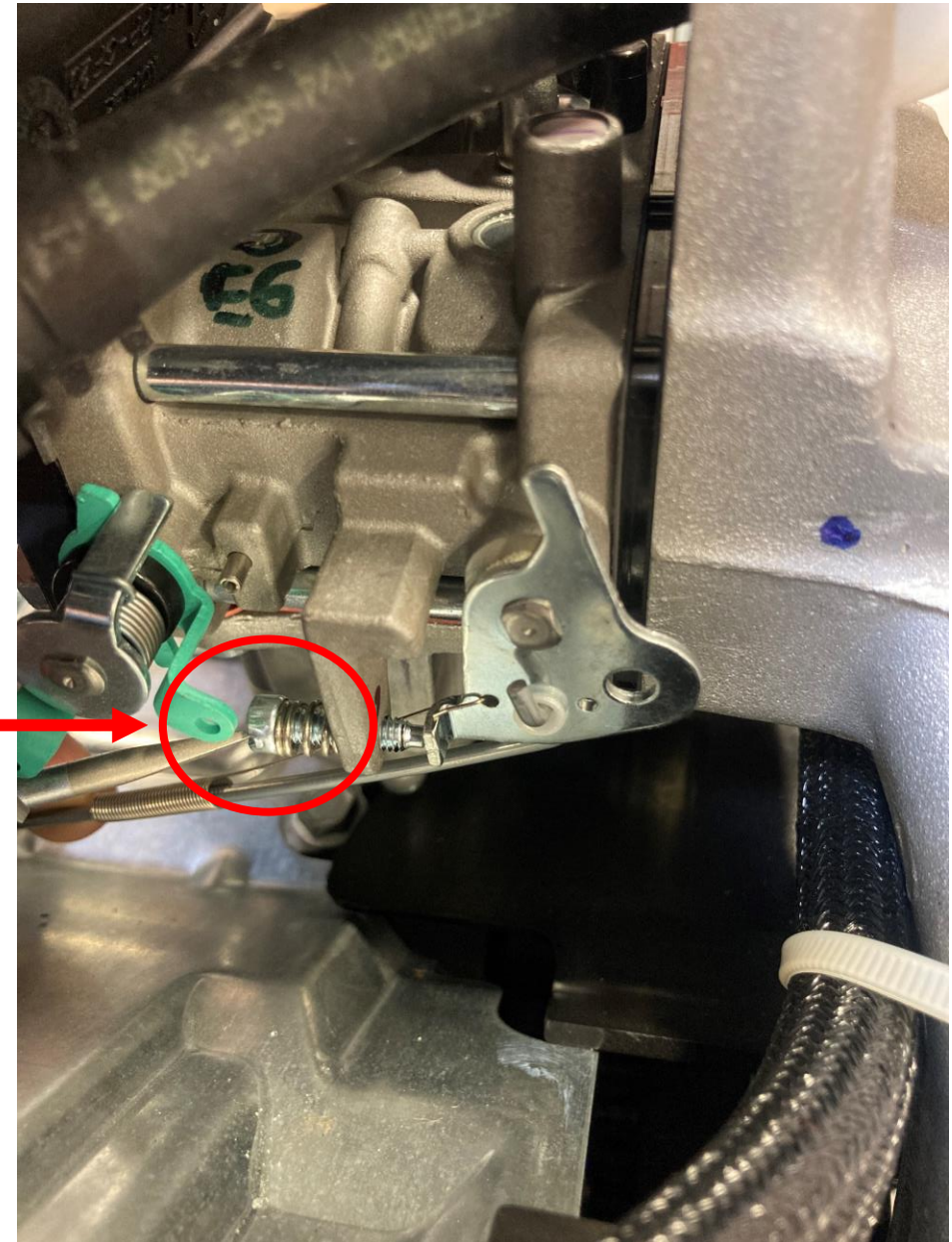

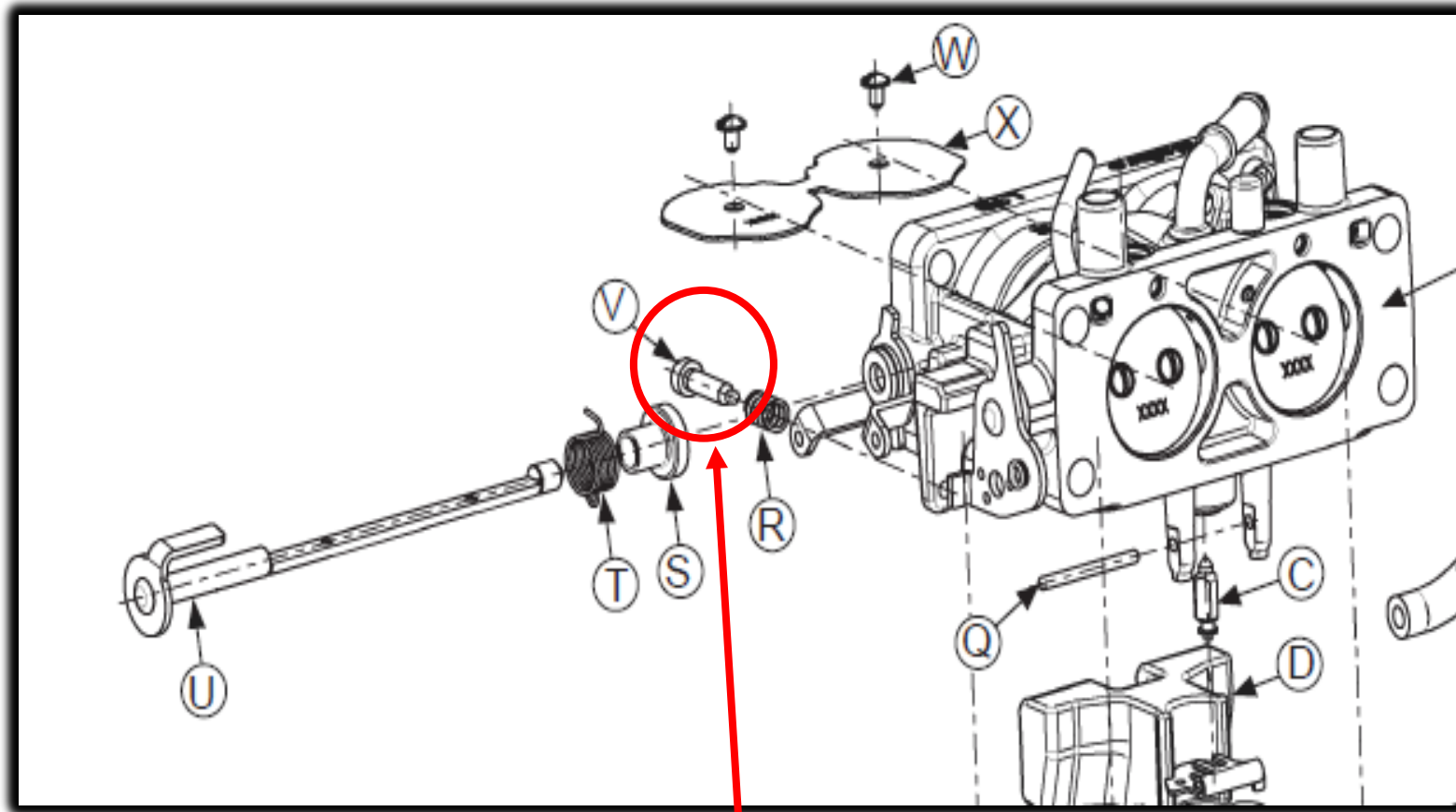

V. Idle adjustment screw